

SGMP 2010 Annual Education Conference CROWN CENTER EXHIBIT HALL

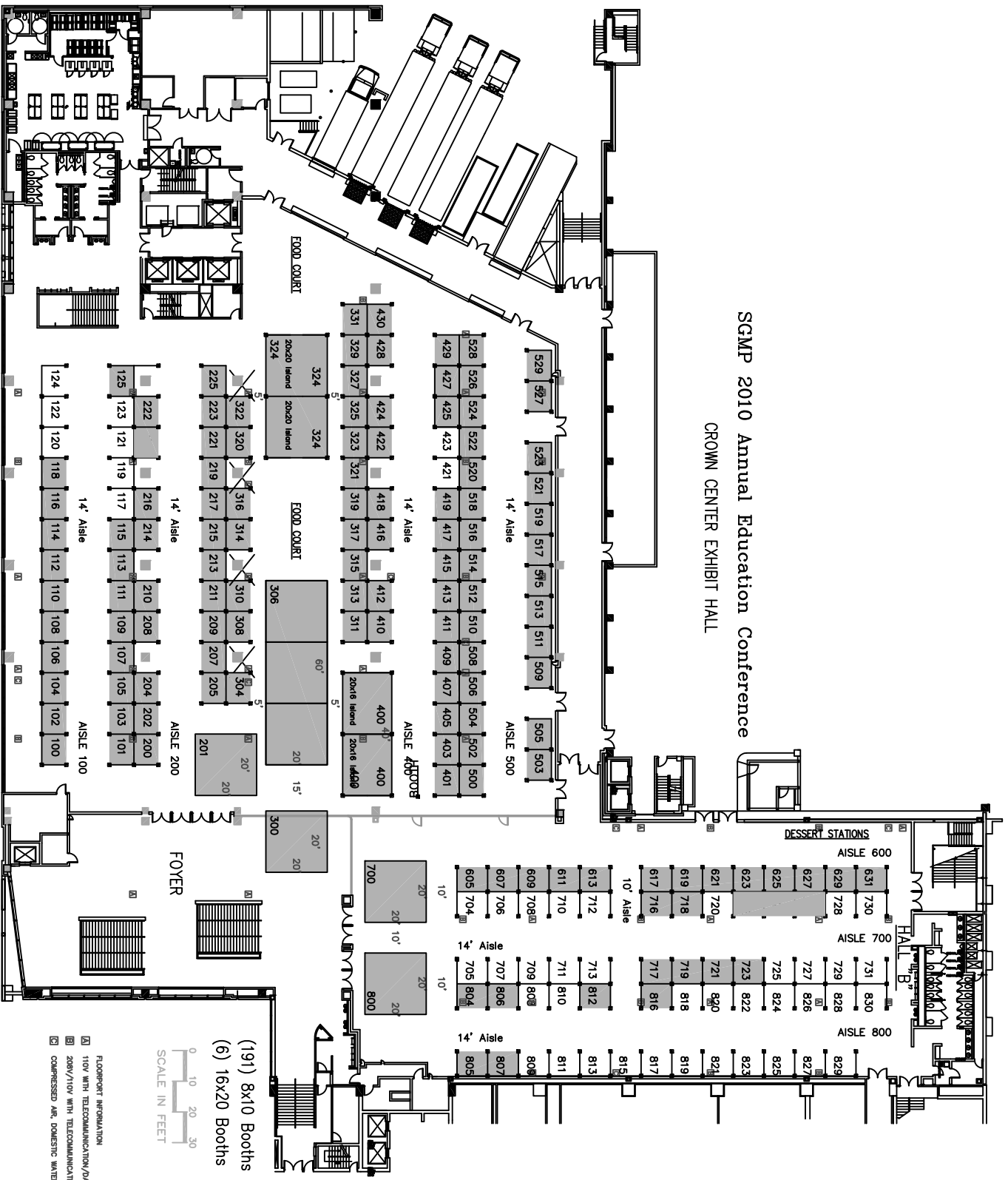

- FLOORPORT INFORMATION:**
- ☐ 110V WITH TELECOMMUNICATION/DATA
 - ☐ 208V/110V WITH TELECOMMUNICATION/DATA
 - ☐ COMPRESSED AIR, DOMESTIC WATER AND FLOOR DRAIN

0 10 20 30
SCALE IN FEET

(191) 8x10 Booths
(6) 16x20 Booths

George Fern Company
Expositions • Corporate Events • Exhibits
Nationwide

751 WYOMING, KANSAS CITY, MISSOURI 64101
(816) 221-0525 FAX (816) 471-1602
E-Mail: kandrewe@georgefern.com

Account Executive: Gary Bates	Revision Date: 03/19/10 #8	Convention City: Kansas City
File Name: 1151-6930-10-R8.dwg 3/19/10	Drawn By: Kristin Andrews	Crown Center Convention Hall

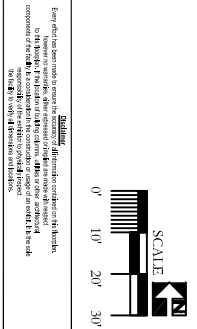

Every effort has been made to ensure the accuracy of this information. However, the user assumes all responsibility for the use of this information. The user agrees to hold the provider harmless from any and all claims, damages, and expenses, including reasonable attorneys' fees, arising from the use of this information. © 2010 George Fern Company. All rights reserved.